

**Main Avenue Mineral Faire**  
**“In the Heart of the Fossil and**  
**Mineral District”**

**Store your materials at your show**  
**space!**

**Show Dates: January 29 – February 13, 2010**

**Spaces available are 8' X 20' X 9' enclosed units each with front entrance 10' X 10' concrete uncovered pad. Each interior space contains overhead lighting and two electrical outlets.**

- ✓ **Dealer and Customer Parking on Premises**
- ✓ **Onsite 24-hour Security**
- ✓ **Show only (\$1250)**
- ✓ **Annual Storage Only (\$1000)**
- ✓ **Show AND Annual Storage (\$2200)**
- ✓ **Tables, show cases, chairs, banners, etc. can be reserved**

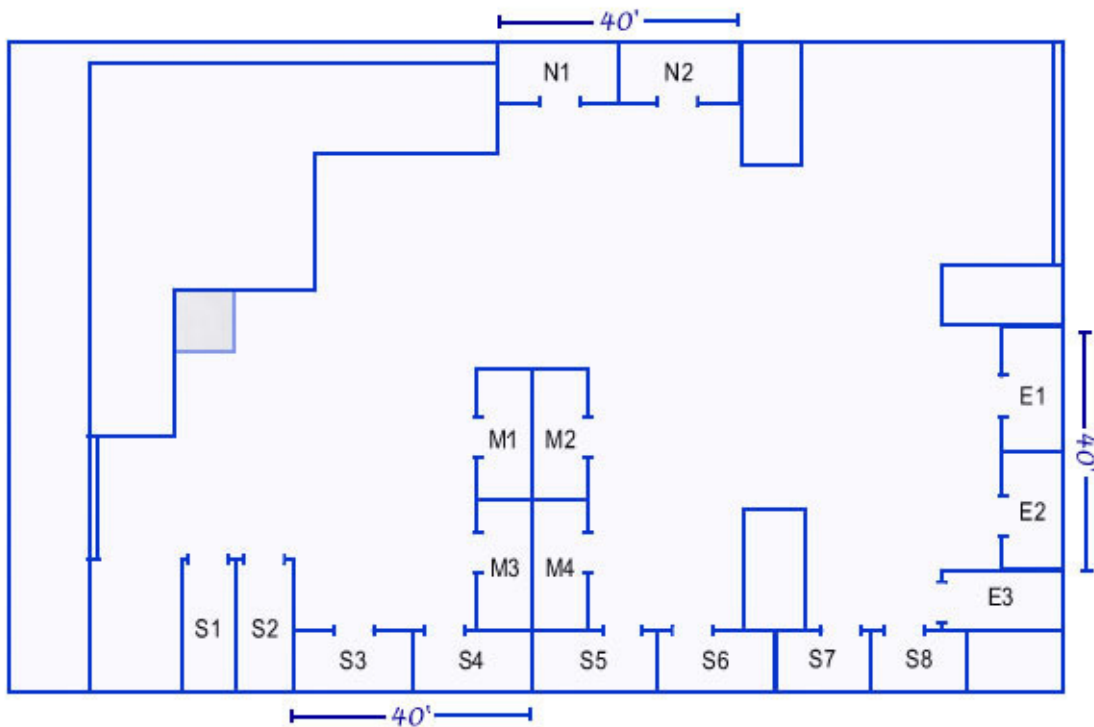

## **APPLICATION FOR EXHIBIT/STORAGE SPACE**

**Company Name:** \_\_\_\_\_

**Company Address:** \_\_\_\_\_

**Telephone:** \_\_\_\_\_

**Contact Name:** \_\_\_\_\_

**Address:** \_\_\_\_\_

**Zip:** \_\_\_\_\_

\_\_\_\_\_  
**Country:** \_\_\_\_\_

**Fax:** \_\_\_\_\_

**Email:** \_\_\_\_\_

**Quantity of spaces  
requested:** \_\_\_\_\_

**Payment: 50% of rental price, non-refundable, to  
be included with this form. Balance due at time  
of check-in.**

**Exhibitor's signature:** \_\_\_\_\_

**Date:** \_\_\_\_\_

**Printed full name:** \_\_\_\_\_